



## PL00291 Series SMD LED Right Angle 1104 Package

### Features

- \*Oval Lens Side View Package 3.0 x 2.0 x 1.0mm
- \*GaN Ultra Bright White Chip used
- \*Low Current Requirements
- \*High Light Output
- \*Compatible with IR Solder-Process
- \*Industry Standard Footprint
- \*2000 or 1000 pcs per Reel
- \*RoHS Compliant

### Absolute Maximum Ratings at T<sub>A</sub> = 25°C

Power Dissipation .....	120mW
Reverse Voltage (<100μA) .....	5.0V
Max Forward Current .....	30mA
Peak Forward Current(1/10 Duty Cycle, 0.1ms Pulse Width) .....	100mA
Operating Temperature Range .....	-40°C to +85°C
Storage Temperature Range .....	-40°C to +85°C
Reflow Soldering Temperature.....	260°C for 10 seconds

### Electrical & Optical Characteristics at T<sub>A</sub> = 25°C

Part Number	Emitting Color	Chip Material	Chromaticity Coordinates Typ		Viewing Angle 2θ1/2 Deg	Forward Voltage @20mA (V)		Luminous Intensity @20mA (mcd)	
			X	Y		Typ	Max	Min	Typ
PL00291-WCW03	White	GaN	0.31	0.31	120°	3.5	4.0	35.0	70.0

Package Dimensions are in **Millimeters**. Tolerance is ± 0.25mm unless otherwise specified.

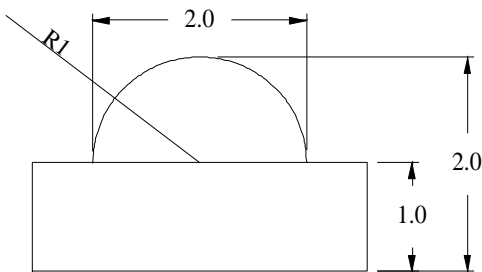
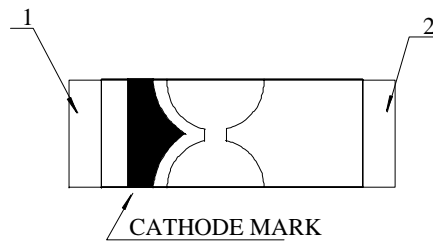
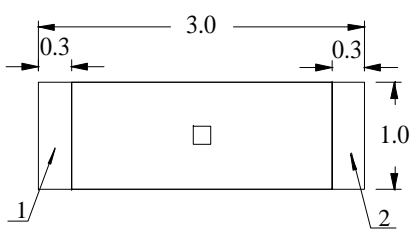

#### Recommended Soldering Pad Layout

